

COUPLER NIPPLE

DIMENSIONS: ASME B16.11-2016, THREADED AND SOCKET WELD END, 3000# 6000#

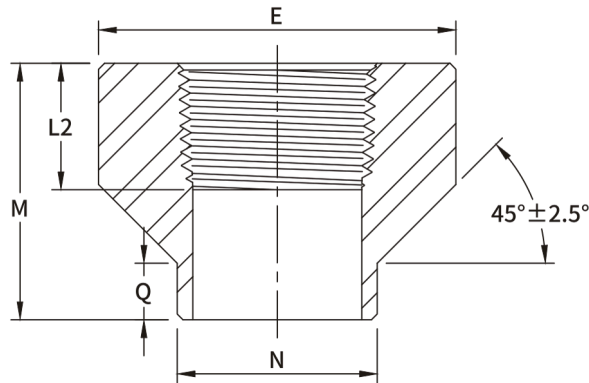

Dimensions are in millimeters.

Threaded						
DN	Nom. Pipe Size	Length of Thread.	N	Q	M	E
		L2(*)				

3000Lb

8	1/4	11.4	17.5	9.5	30.2	23.8
10	3/8	12.4	20.7	9.5	30.2	27.0
15	1/2	14.9	23.8	9.5	33.4	33.4
20	3/4	16.8	27.0	9.5	34.9	38.1
25	1	19.6	33.4	9.5	42.9	46.1
32	1-1/4	21.9	42.9	9.5	47.6	55.6
40	1-1/2	22.7	49.2	9.5	50.8	63.5
50	2	23.9	61.9	9.5	57.2	79.4
65	2-1/2	30.5	73.0	9.5	63.5	92.1
80	3	32.8	88.9	9.5	69.9	111.1
100	4	34.6	114.3	9.5	76.2	141.3

6000Lb

8	1/4	11.4	17.5	9.5	30.2	25.4
10	3/8	12.4	20.7	9.5	30.2	31.8
15	1/2	14.9	23.8	9.5	33.4	38.1
20	3/4	16.8	27.0	9.5	34.9	44.5
25	1	19.6	33.4	9.5	42.9	57.2
32	1-1/4	21.9	42.9	9.5	47.6	63.5
40	1-1/2	22.7	49.2	9.5	50.8	76.2
50	2	23.9	61.9	9.5	57.2	92.1
65	2-1/2	30.5	73.0	9.5	63.5	108.0
80	3	32.8	88.9	9.5	69.9	127.0
100	4	34.6	114.3	9.5	76.2	158.8

DIMENSIONAL TOLERANCE OF ASME B16.11

ASME B16.11-2016

Unit : mm

Item	N	Q	M	E
1/4"~1-1/2"	+1.5/-0.0	±0.8	+0.8/-0.0	+1.5/-0.0
2"~4"	+1.5/-0.0	±0.8	+1.5/-0.0	+1.5/-0.0

(*) Dimension L2 is the length of useful thread. The length of useful thread shall be required by American National Standard for pipe threads (ANSI / ASME B1.20.1).

COUPLER THREADED NIPPLE

DIMENSIONS: ASME B16.11-2016, THREADED AND
SOCKET WELD END, 3000# 6000#

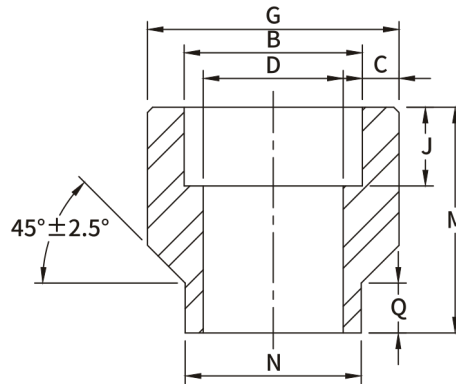

Dimensions are in millimeters.

Socket Welding									
DN	Nom. Pipe Size	B ⁽¹⁾	C	D ⁽¹⁾	J	N	Q	M	G

3000Lb

8	1/4	14.2	3.80	9.3	10.5	17.5	9.5	30.2	23.8
10	3/8	17.6	4.05	12.6	10.5	20.7	9.5	30.2	27.0
15	1/2	21.8	4.70	15.8	12.5	23.8	9.5	33.4	33.4
20	3/4	27.2	4.90	21.0	14.0	27.0	9.5	34.9	38.1
25	1	33.9	5.70	26.7	15.0	33.4	9.5	42.9	46.1
32	1-1/4	42.7	6.10	35.1	17.0	42.9	9.5	47.6	55.6
40	1-1/2	48.8	6.40	40.9	17.5	49.2	9.5	50.8	63.5
50	2	61.2	6.95	52.5	22.0	61.9	9.5	57.2	79.4
65	2-1/2	73.9	8.80	62.7	22.0	73.0	9.5	63.5	92.1
80	3	89.8	9.55	78.0	22.0	88.9	9.5	69.9	111.1
100	4	115.2	10.70	102.3	22.0	114.3	9.5	76.2	141.3

6000Lb

8	1/4	14.2	4.60	6.4	10.5	17.5	9.5	30.2	25.4
10	3/8	17.6	5.05	9.2	10.5	20.7	9.5	30.2	31.8
15	1/2	21.8	6.00	11.8	12.5	23.8	9.5	33.4	38.1
20	3/4	27.2	7.00	15.6	14.0	27.0	9.5	34.9	44.5
25	1	33.9	7.95	20.7	15.0	33.4	9.5	42.9	57.2
32	1-1/4	42.7	7.95	29.5	17.0	42.9	9.5	47.6	63.5
40	1-1/2	48.8	8.95	34.0	17.5	49.2	9.5	50.8	76.2
50	2	61.2	10.95	42.9	22.0	61.9	9.5	57.2	92.1

DIMENSIONAL TOLERANCE OF ASME B16.11

ASME B16.11-2016

Unit : mm

Item	N	Q	M	E
1/4"~1-1/2"	+1.5/-0.0	±0.8	+0.8/-0.0	+1.5/-0.0
2"~4"	+1.5/-0.0	±0.8	+1.5/-0.0	+1.5/-0.0

(1) Tolerance see page 11.