

SERIES B CLASS 75 FLANGE

ASME B16.47-2017

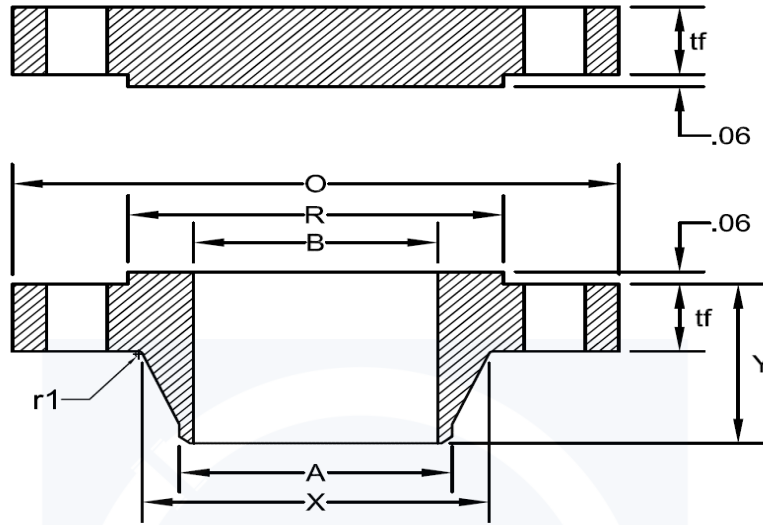

Minimum Thickness										Bolt		
Nominal Pipe Size	Outside Diameter <i>O</i>	Welding Neck (Note-2) <i>t_f</i>	Blind <i>t_f</i>	Length Through Hub <i>Y</i>	Diameter of Hub <i>X</i>	Diameter of Hub Top <i>A</i>	Diameter of Raised Face <i>R</i>	Minimum Fillet Radius <i>r₁</i>	Bore <i>B</i>	Diameter of Bolt Circle	Number of Holes	Diameter of Holes
26	30.00	1.25	1.25	2.25	26.62	26.06	27.75	0.31	Note-1	28.50	36	0.75
28	32.00	1.25	1.25	2.38	28.62	28.06	29.75	0.31	Note-1	30.50	40	0.75
30	34.00	1.25	1.25	2.50	30.62	30.06	31.75	0.31	Note-1	32.50	44	0.75
32	36.00	1.32	1.38	2.69	32.62	32.06	33.75	0.31	Note-1	34.50	48	0.75
34	38.00	1.32	1.44	2.82	34.62	34.06	35.75	0.31	Note-1	36.50	52	0.75
36	40.69	1.38	1.61	3.32	36.81	36.06	38.00	0.38	Note-1	39.06	40	0.88
38	42.69	1.44	1.69	3.44	38.81	38.06	40.00	0.38	Note-1	41.06	40	0.88
40	44.69	1.44	1.69	3.57	40.81	40.06	42.00	0.38	Note-1	43.06	44	0.88
42	46.69	1.50	1.82	3.69	42.81	42.06	44.00	0.38	Note-1	45.06	48	0.88
44	49.25	1.63	1.88	4.07	44.88	44.06	46.25	0.38	Note-1	47.38	36	1.00
46	51.25	1.69	1.94	4.19	46.88	46.06	48.25	0.38	Note-1	49.38	40	1.00
48	53.25	1.75	2.07	4.32	48.88	48.06	50.25	0.38	Note-1	51.38	44	1.00
50	55.25	1.82	2.13	4.50	50.94	50.06	52.25	0.38	Note-1	53.38	44	1.00
52	57.38	1.82	2.19	4.69	52.94	52.06	54.25	0.38	Note-1	55.50	48	1.00
54	59.38	1.88	2.32	4.88	55.00	54.06	56.25	0.38	Note-1	57.50	48	1.00
56	62.00	1.94	2.38	5.25	57.12	56.06	58.50	0.44	Note-1	59.88	40	1.13
58	64.00	2.00	2.44	5.38	59.12	58.06	60.50	0.44	Note-1	61.88	44	1.13
60	66.00	2.13	2.57	5.63	61.12	60.06	62.50	0.44	Note-1	63.88	44	1.13

Notes:
 (1) To be specified by the Customer.
 (2) When these flanges are required with flat face, the flat face may be either the full *t_f* dimension thickness plus 0.06 in. or the *t_f* dimension thickness without the raised face height.