

SERIES B CLASS 600 FLANGE

ASME B16.47-2017

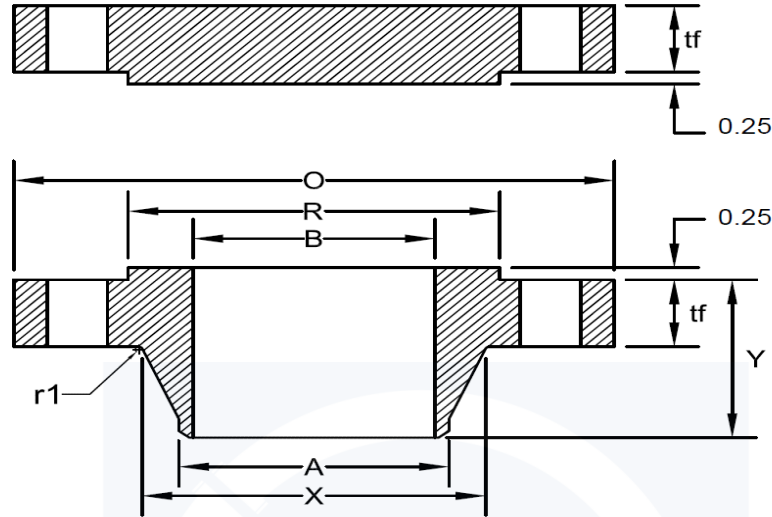

Minimum Thickness										Bolt		
Nominal Pipe Size	Outside Diameter <i>O</i>	Welding Neck (Note-2) <i>t_f</i>	Blind <i>t_f</i>	Length Through Hub <i>Y</i>	Diameter of Hub <i>X</i>	Diameter of Hub <i>A</i>	Diameter of Raised Face <i>R</i>	Minimum Fillet Radius <i>r_f</i>	Bore <i>B</i>	Diameter of Bolt Circle	Number of Holes	Diameter of Holes
26	35.00	4.38	4.38	7.12	27.50	26.00	28.62	0.50	Note-1	31.75	28	1.76
28	37.50	4.56	4.56	7.50	29.62	28.00	30.88	0.50	Note-1	34.00	28	1.88
30	40.25	4.94	5.00	8.06	31.75	30.00	33.12	0.50	Note-1	36.50	28	2.00
32	42.75	5.12	5.31	8.50	33.88	32.00	35.25	0.50	Note-1	38.75	28	2.13
34	45.75	5.56	5.68	9.19	36.00	34.00	37.50	0.56	Note-1	41.50	24	2.38
36	47.75	5.75	5.94	9.56	38.12	36.00	39.75	0.56	Note-1	43.50	28	2.38
38	-	-	-	-	-	-	-	-	-	-	-	-
40	-	-	-	-	-	-	-	-	-	-	-	-
42	-	-	-	-	-	-	-	-	-	-	-	-
44	-	-	-	-	-	-	-	-	-	-	-	-
46	-	-	-	-	-	-	-	-	-	-	-	-
48	-	-	-	-	-	-	-	-	-	-	-	-
50	-	-	-	-	-	-	-	-	-	-	-	-
52	-	-	-	-	-	-	-	-	-	-	-	-
54	-	-	-	-	-	-	-	-	-	-	-	-
56	-	-	-	-	-	-	-	-	-	-	-	-
58	-	-	-	-	-	-	-	-	-	-	-	-
60	-	-	-	-	-	-	-	-	-	-	-	-

Notes:

- (1) To be specified by the Customer.
- (2) When these flanges are required with flat face, the flat face may be either the full *t_f* dimension thickness plus 0.25 in. or the *t_f* dimension thickness without the raised face height.